

Total Impervious Coverage for all Lots = 3.4%
Total Impervious Coverage within 500 ft = 4.4%
Total Impervious Coverage within 250 ft = 4.2%

Camp Lake

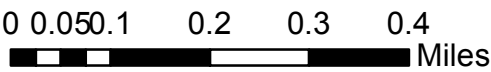

Impervious Surface Coverage by Parcel

- | | |
|---------------|-----------|
| Roads | 0 - 15 % |
| Section Lines | 15 - 20 % |
| City | 20 - 25 % |
| Parcels | 25+ % |
| Lakes | |

This data is provided on an "AS-IS" basis, without warranty of any type, expressed or implied, including but not limited to any warranty as to their performance, merchantability, or fitness for any particular purpose.



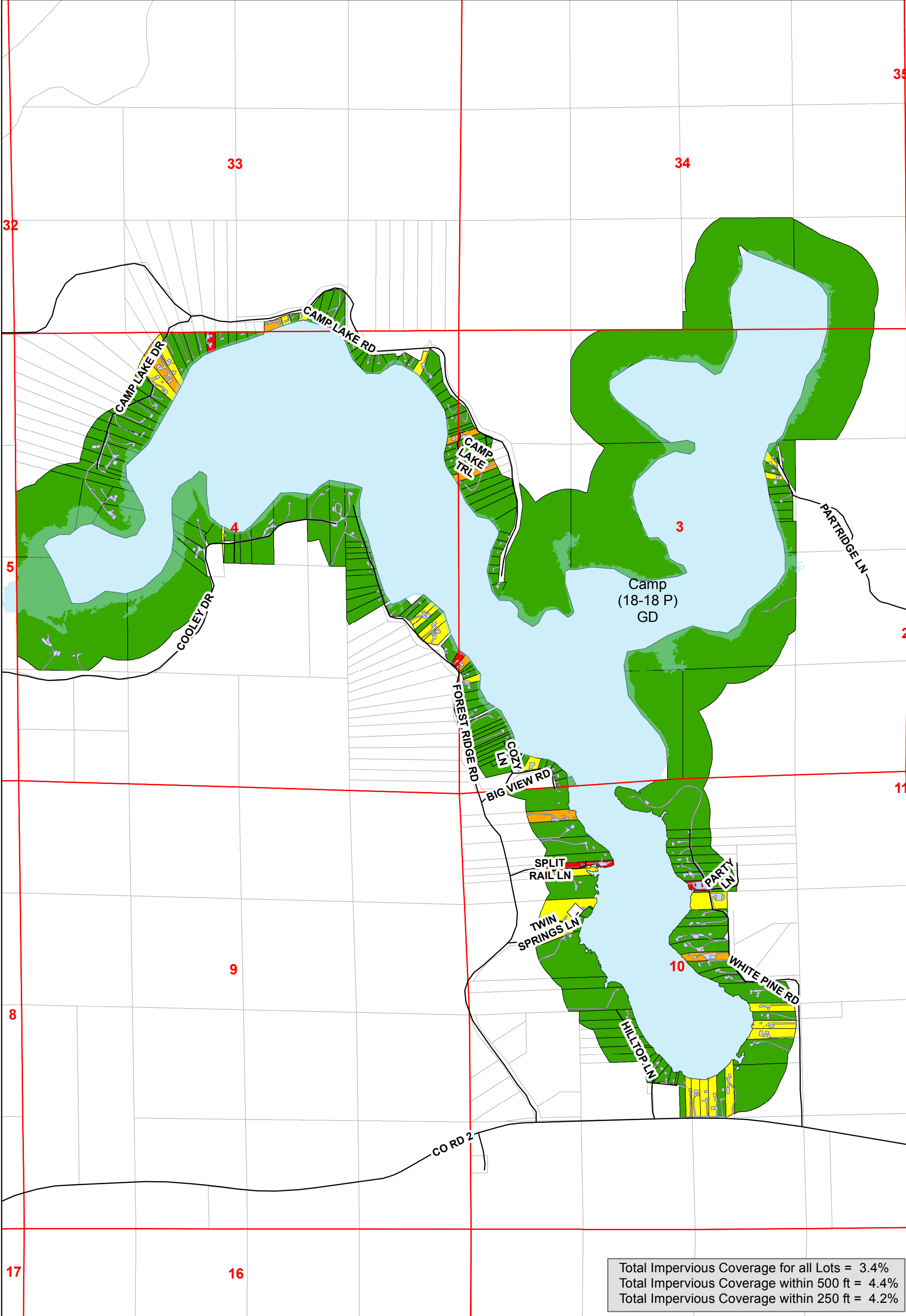

Total Impervious Coverage for all Lots = 3.4%
Total Impervious Coverage within 500 ft = 4.4%
Total Impervious Coverage within 250 ft = 4.2%

Camp Lake

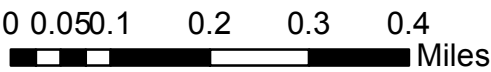

Impervious % within 500 ft of Shoreline

- | | |
|---------------|-----------|
| Roads | 0 - 15 % |
| Section Lines | 15 - 20 % |
| City | 20 - 25 % |
| Parcels | 25+ % |
| Lakes | |

This data is provided on an "AS-IS" basis, without warranty of any type, expressed or implied, including but not limited to any warranty as to their performance, merchantability, or fitness for any particular purpose.



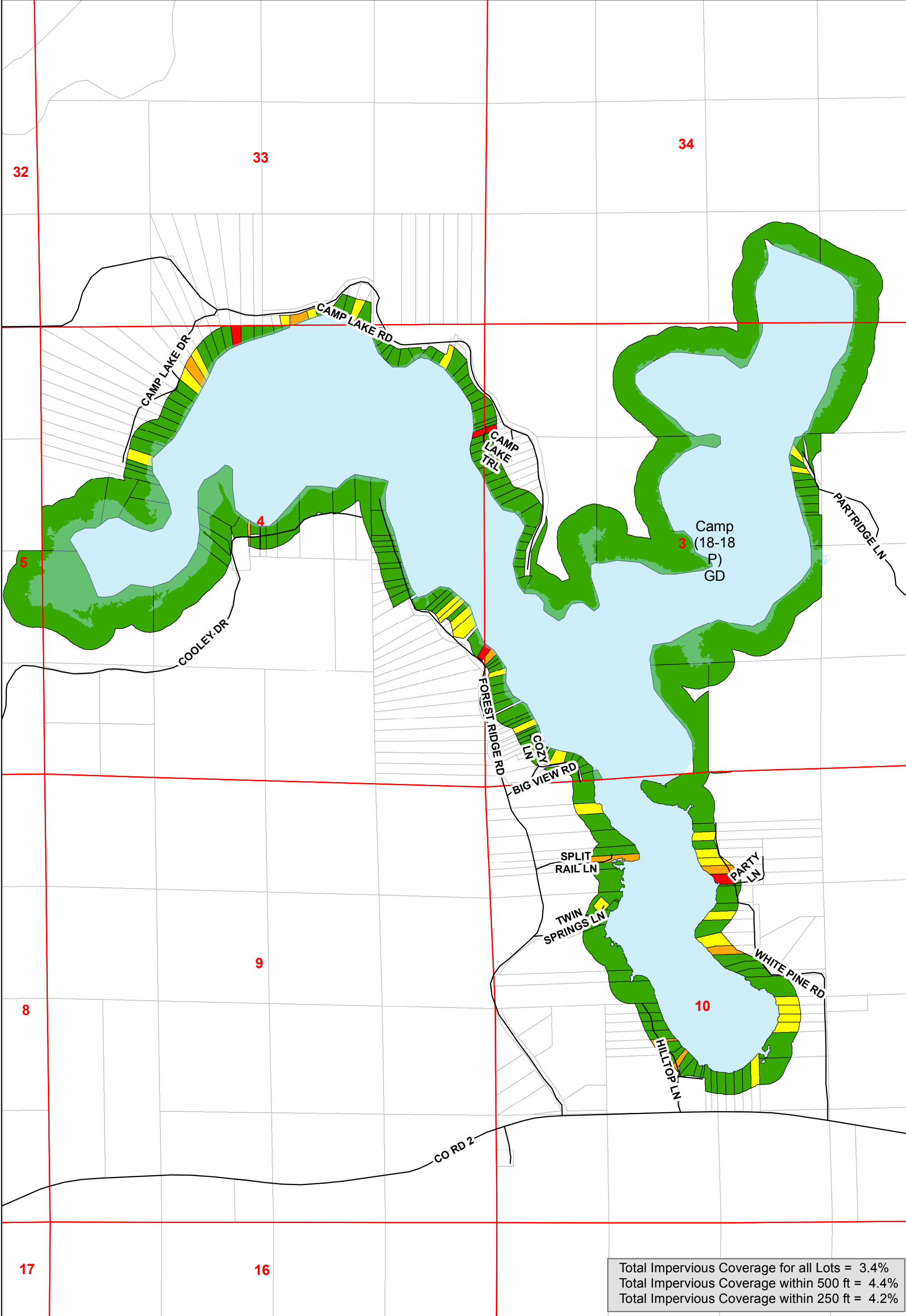

Total Impervious Coverage for all Lots = 3.4%
Total Impervious Coverage within 500 ft = 4.4%
Total Impervious Coverage within 250 ft = 4.2%

This data is provided on an "AS-IS" basis, without warranty of any type, expressed or implied, including but not limited to any warranty as to their performance, merchantability, or fitness for any particular purpose.



Camp Lake

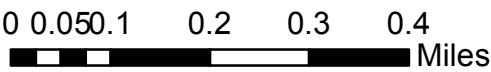

Impervious % within 250 ft of Shoreline

- | | | | |
|--|---------------|--|-----------|
| | Roads | | 0 - 15 % |
| | Section Lines | | 15 - 20 % |
| | City | | 20 - 25 % |
| | Parcels | | 25+ % |
| | Lakes | | |

