

THIS DRAWING IS A COMPILATION OF RECORDS AS THEY APPEAR IN THE CROW WING COUNTY OFFICES AFFECTING THE AREA SHOWN AND IS TO BE USED ONLY FOR REFERENCE PURPOSES. THE COUNTY IS NOT RESPONSIBLE FOR ANY INNACCURACIES HERIN CONTAINED.

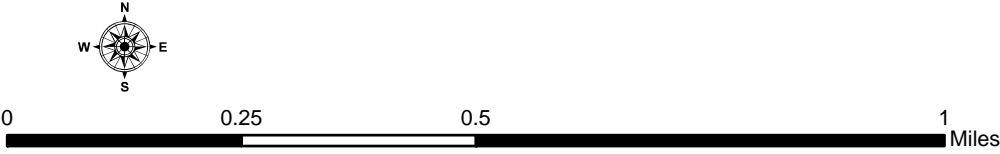

Big Trout Lake

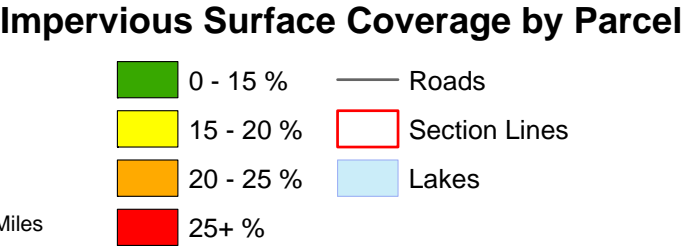

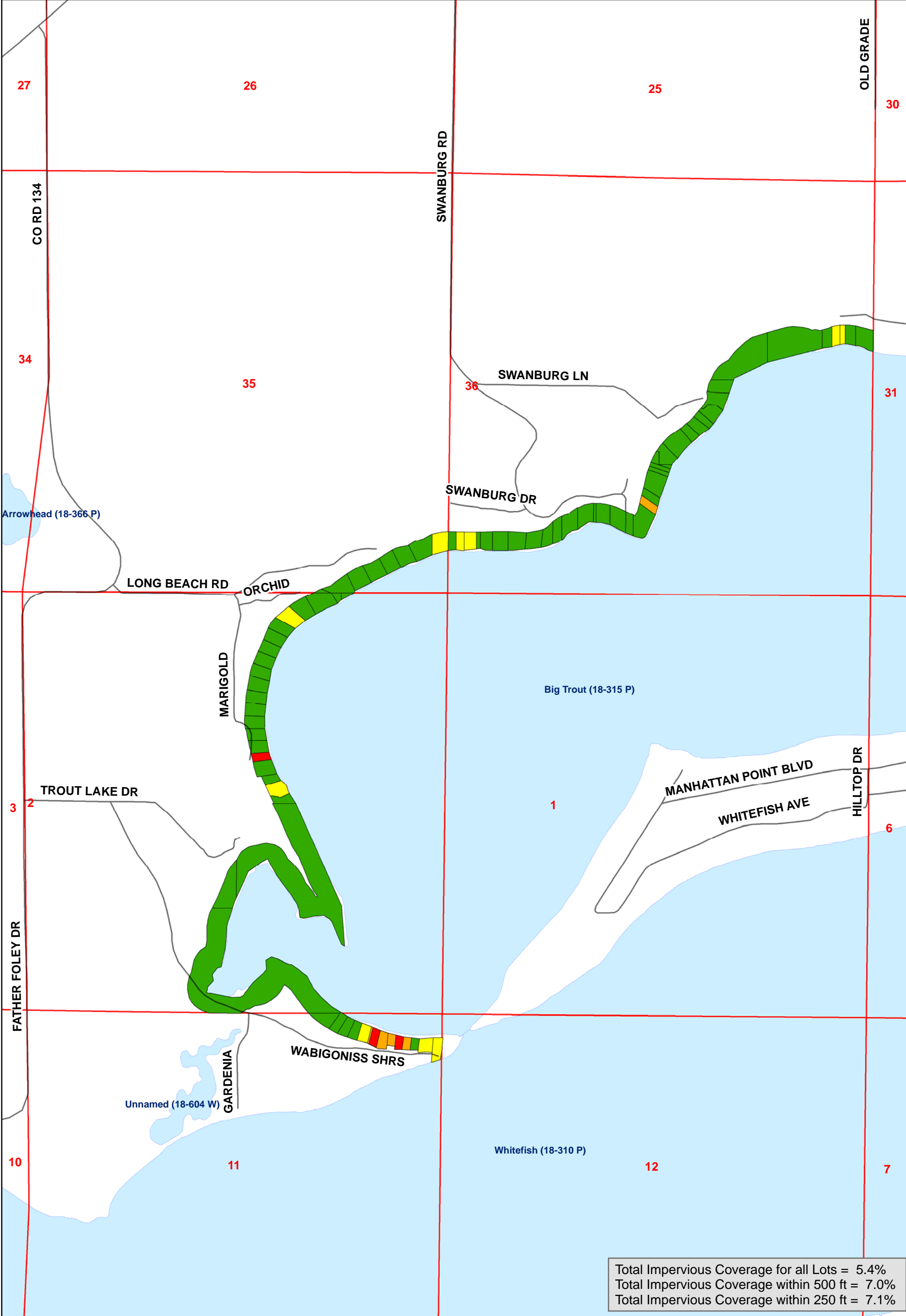

Total Impervious Coverage for all Lots = 5.4%
Total Impervious Coverage within 500 ft = 7.0%
Total Impervious Coverage within 250 ft = 7.1%

THIS DRAWING IS A COMPILATION OF RECORDS AS THEY APPEAR IN THE CROW WING COUNTY OFFICES AFFECTING THE AREA SHOWN AND IS TO BE USED ONLY FOR REFERENCE PURPOSES. THE COUNTY IS NOT RESPONSIBLE FOR ANY INNACCURACIES HERIN CONTAINED.

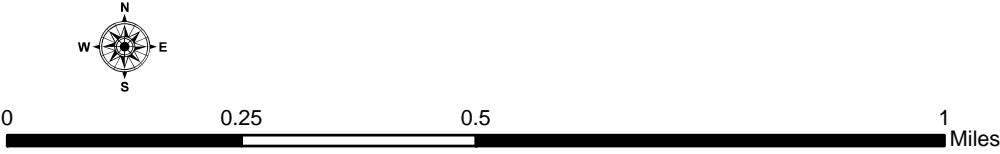

Big Trout Lake

Impervious % within 250 ft of Shoreline

- | | |
|-----------|-----------------|
| 0 - 15 % | — Roads |
| 15 - 20 % | □ Section Lines |
| 20 - 25 % | □ Lakes |
| 25+ % | |



THIS DRAWING IS A COMPILATION OF RECORDS AS THEY APPEAR IN THE CROW WING COUNTY OFFICES AFFECTING THE AREA SHOWN AND IS TO BE USED ONLY FOR REFERENCE PURPOSES. THE COUNTY IS NOT RESPONSIBLE FOR ANY INNACCURACIES HERIN CONTAINED.



Big Trout Lake

